

INSPECTION HATCH

Installation and User Instructions, models: PTLdB | EI30PTL | EI60PTL

PTLdB Sound insulated inspection hatch for wall or ceiling installation

EI30PTL Fire-resistant hatch (EI30) for wall or ceiling installation

EI60PTL Fire-resistant hatch (EI60) for wall installation only



QUICK FASTENING MECHANISM FOR WALL OR CEILING (THICKNESS 15–30 MM)

The quick fastening mechanism is designed for double board structures. The frame also includes holes for screw or nail mounting.

1. Mark the position of the inspection hatch and carefully check diagonal measurements. Cut the opening to the correct dimensions.
2. Open the hatch and place the frame into the opening. Pay attention to the weight of the door, especially for ceiling installations – support the door to prevent uncontrolled opening.
3. Ensure the frame fits tightly against the board surface. Push all quick fasteners behind the board using, for example, a screwdriver. The more the fasteners are turned, the tighter they grip.
4. Finally, close and lock the hatch cover, and make sure the frame is tight against the surface.

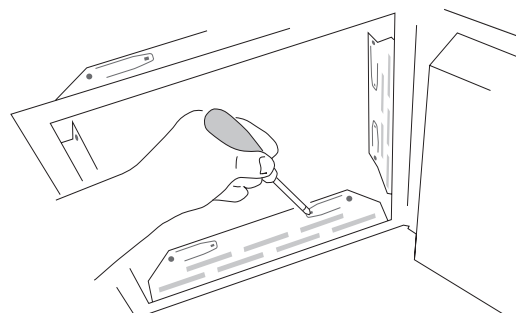
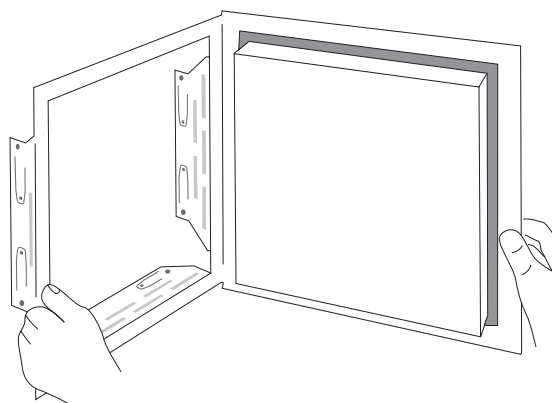

ALTERNATIVE INSTALLATION – SCREWS OR NAILS

Attach the panel through all mounting holes (Ø 6.0 mm) using suitable nails or screws.

- For metal or wooden frames: screws min. 4.5×35 mm
- For lightweight concrete or block walls: nails min. 2.9×65 mm

DIMENSIONS

- Installation opening = nominal hatch size
- Outer cover size = nominal size + 35 mm
- Frame depth = 42 mm from board surface

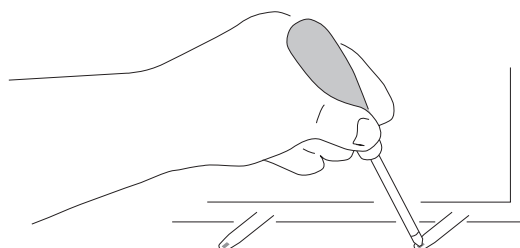
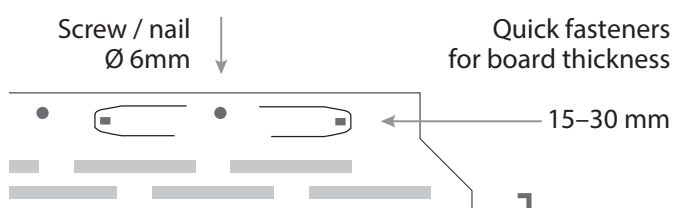

FIRE-RESISTANT INSPECTION HATCH – EI30PTL & EI60PTL

EI30PTL fire-resistant hatch EI30 **for wall or ceiling installation**

EI60PTL fire-resistant hatch EI60 **for wall installation only**

These hatches are for indoor use only and must always be installed in accordance with the manufacturer's instructions.

Do not modify the hatch structure or remove any fire seals or insulation.



WHEN INSTALLING, CONSIDER:

- Applicable and local building regulations
- The hatch size and its position in the building
- Installation site structure and fire compartmentation requirements
- Contact the local building authority for additional guidance

SAFETY AND MAINTENANCE

- Do not install a damaged hatch. If the hatch is damaged, it must be replaced.
- Always support the hatch door during opening – especially in ceiling installations.
- The hatch must always remain closed and locked using a 7 mm triangular lock or similar.

DOCUMENTATION AND INSTRUCTIONS

- Installation instructions are provided with the product and are available at www.kiilax.fi
- Type-approved standard sizes 150 × 150 – 600 × 600 mm. The type approval certificate is available for download at www.kiilax.fi
- Include installation instructions and all fire hatch information in the site's project documentation (e.g., building manual).

SOUND INSULATION – EI30PTL & EI60PTL

Fire-resistant inspection hatches have been tested and classified according to ISO 717-1:1996:

Model	Size mm	Sound insulation
		Dn,e,w
EI30PTL2020	200 × 200	45 dB
EI30PTL6060	600 × 600	38 dB
EI60PTL3030	300 × 300	43 dB

The complete sound insulation test reports are available at: www.kiilax.fi.

ADDITIONAL INFORMATION

More information on regulations of fire safety and noise control in buildings:

- Requirements for fire-separating walls and ceilings: Ministry of the Environment Decree on Fire Safety of Buildings 848/2017 | www.finlex.fi
- Ministry of the Environment Decree on the Acoustic Environment of Buildings 796/2017 | www.finlex.fi
- Contact the local building authority for more information, if necessary.

CONTACT INFORMATION

For all product-related inquiries, please contact the manufacturer, Kiilax Oy:

info@kiilax.fi

www.kiilax.fi/en/

